



UL Protection Methods
UL 913 CSA C22.2 No.157
Class I, II, III
Divisions 1 & 2
Groups C-G



VISION LED HEADLAMP #200501



BRIGHT STAR TECHNOLOGY FOR **BEST IN CLASS OPTICAL VISION**
LETS YOU SEE BETTER!

- LARGE PUSH BUTTON SWITCH
- LIGHTWEIGHT POLYMER HOUSING DESIGN
- ADJUSTABLE MOUNT FOR GREATER VISION
- LOW PROFILE FOR USE WITH VISORS AND SHIELDS
- MULTI-USE HIGH VISIBILITY ADJUSTABLE STRAP SECURELY ADHERES TO HELMETS, HARDHATS AND HEADS
- WATER-RESISTANT DESIGN SUITABLE FOR OUTDOOR USE IN WET ENVIRONMENT



4 LIGHT MODES

HIGH SPOT, LOW SPOT, HIGH FLOOD, LOW FLOOD

ALLOWS USER TO CHOOSE BEAM THAT BEST SUITS THEIR NEED AT ANY GIVEN TIME

MODE	SETTING	OUTPUT LUMENS	PEAK BEAM INTENSITY CANDELA	BEAM DISTANCE METERS	RUN TIME HOURS	POWER SOURCE	WEIGHT
SPOT	HIGH	185	1000	63	6.75	3 AAA Batteries	3.5 oz. with Batteries
	LOW	65	320	35	20		
FLOODLIGHT	HIGH	20	10	6	>70hrs		
	LOW	10	6	4	>140hrs		

UPC# 016731205010

WWW.SAFETYWARE.COM



6.75hrs
RUN TIME



1m
IMPACT RESISTANCE

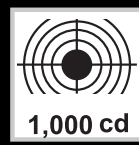

1,000 cd
PEAK BEAM INTENSITY



185 LUMENS
OUTPUT



WATER RESISTANCE



63m
BEAM DISTANCE

VISION LED HEADLAMP

#200501

Safetyware
SAFETYWARE GROUP



ADJUSTABLE MOUNT



LOW PROFILE FOR USE WITH VISORS

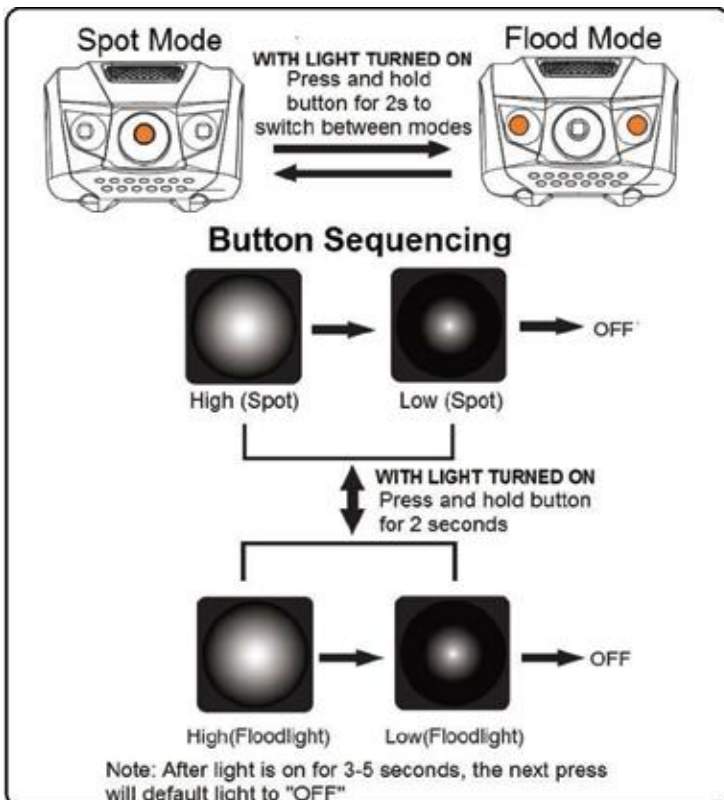
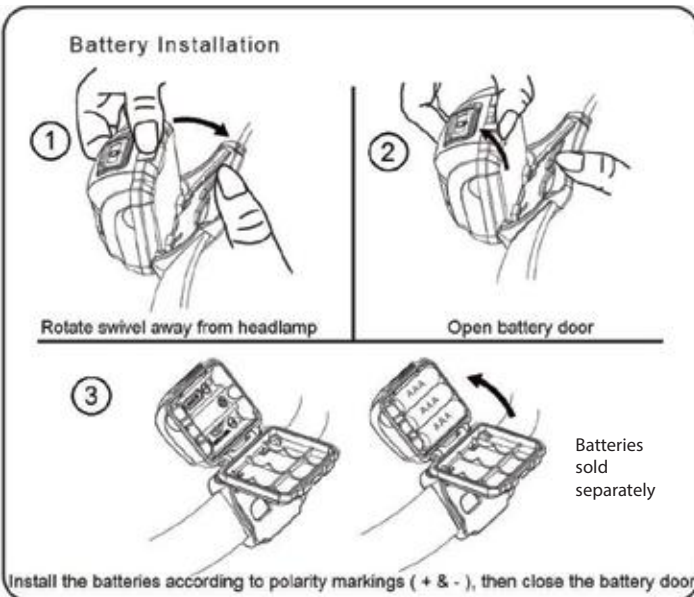

SAFETYWARE SDN BHD

(632971 - X)

1300-88-3882

PLOT 237, LENGKOK PERINDUSTRIAN

BUKIT MINYAK 3, BUKIT MINYAK

INDUSTRIAL ESTATE,

14100 SIMPANG AMPAT, PENANG, MALAYSIA.

WWW.SAFETYWARE.COM

INFO@SAFETYWARE.COM