

# Product leaflet

|                                  |                  |                     |
|----------------------------------|------------------|---------------------|
| <b>Product</b>                   | <b>Model No.</b> | <b>Ordering No.</b> |
| Powered air purifying respirator | SR 500           | H06-0112            |

## Product Description

The SR 500 is a battery-powered fan that, together with a filter and an approved head top, is included in the Sundström fan-assisted respiratory protective device systems. The SR 500 can be used as an alternative to filter respirators in all situations in which these are recommended. This applies particularly to work that is hard, warm or of long duration.

The human interface may consist of a hood, face shield, half mask or full face mask. The fan is equipped with a filter, and the filtered air is fed through a hose to the human interface. The pressure then generated prevents surrounding pollutants from penetrating into the mask.

### The characteristics of the SR 500 are as follows:

The battery is of lithium-ion type • Two battery alternatives, i.e. STD (Standard 2.2 Ah) and HD (Heavy Duty 3.6 Ah) • The charging time for the Standard battery is around 1.5 hours and for the Heavy Duty battery, about 2 hours • Equipped with two filters/combined filters • Operating time of up to 12 hours • The same control is used for starting, stopping and selection of operating status • Display with symbols • Equipped with automatic air flow control with compensation for air pressure and temperature • Can be used together with hoods SR 520, SR 530, SR 561, SR 562, SR 601, SR 602 face shield SR 570, half mask SR 900, full face mask SR 200, welding shield SR 592, helmet with visor SR 580 or welding shield/helmet with visor SR 584/SR 580. Electronics ingress protection is approved in IP class IP67 according to IEC / EN 60529.

The SR 500 is also available in an explosion-protected version designated the SR 500 EX for use in a potentially explosive atmosphere. See the separate product leaflet.

## Technical specification

|   | SR 500   | EN 12941:1998 + A2:2008 | EN12942:1998 + A2:2008 |
|---|--|-------------------------|------------------------|
| <b>Air flow, min/max</b>  | 175/240 l/min                                      | ≥ 120 l/min             | -                      |
| <b>STD-battery/HD-Battery</b>   | 14,4 V 2,25 Ah/3,5 Ah                              | -                       | -                      |
| <b>Operating times at 175/240 l/min:</b>  |  |                         |                        |
| <b>P3, STD-battery</b>  | 7 h/4 h  | ≥ 4 h                   | ≥ 4 h                  |
| <b>P3, HD- battery</b>  | 12 h/6 h   | ≥ 4 h                   | ≥ 4 h                  |
| <b>Weight with STD-battery and P3 filter</b>  | ≈ 1 400 g  | ≤ 3,500 g               | ≤ 3,500 g              |
| <b>Service conditions</b>   | -10 °C to +55 °C, < 90 % RH, 600 to 1200 hPa       | -                       | -                      |
| <b>Storage conditions</b>   | -20 °C to +40 °C, < 90 % RH                        | -                       | -                      |
| <b>Low flow warning level</b>   | < 175 l/min  | ≤ 175 l/min             | ≤ 175 l/min            |
| <b>Assigned Protection Factor<sup>1</sup>: SR 520, SR 530, SR 561/562, SR 580, SR 584, SR 601, SR 602</b> | 40 (TH3)   | -                       | -                      |
| <b>Assigned Protection Factor<sup>1</sup> SR 200</b>  | 40 (TM3)   | -                       | -                      |
| <b>Nominal Protection Factor<sup>2</sup> SR 520, SR 530, SR 561/562, SR 580, SR 584, SR 601, SR 602</b>   | 500 (TH3)  | -                       | -                      |
| <b>Nominal Protection Factor<sup>2</sup> SR 200</b>   | 2000 (TM3)   | -                       | -                      |
| <b>Approvals</b>  | EN 12941:1998 + A2:2008<br>EN 12942:1998 + A2:2008 | -                       | -                      |

1) Specified in BS 4275 and applies generally to all approved fan-assisted respiratory protective devices, regardless of the test results.

2) According to EN 529:2005.



**Safetyware**  
SAFETYWARE GROUP  
Responsibility & Care

SAFETYWARE SDN BHD  
2820103001 | 025019132  
Pusat 325 Komplek Perumahan Tumbuh Melayu 3,  
Road 14/100K, Petaling Jaya,  
14100 Sepang, Selangor, Malaysia  
Tel: +603-4332 0882 (4 Lines) | www.safetyware.com  
Fax: +603-4330 3283 | info@safetyware.com

**Sundström**  
www.srsafety.com

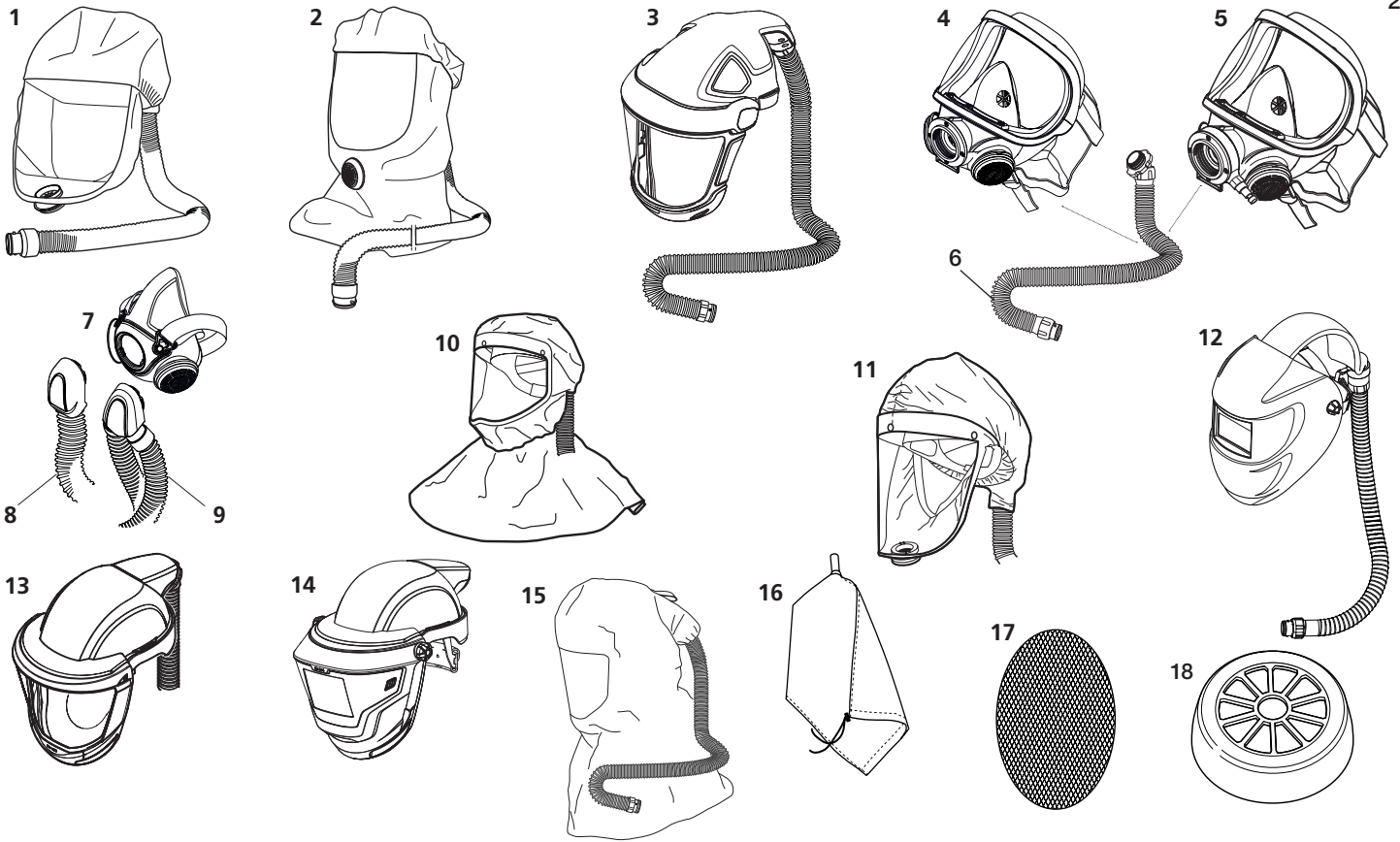

**Head-tops, spare parts and accessories**

**Item**

| No. Part   | Ordering No. |
|--|--------------|
| 1. Hood SR 520 M/L                                 | H06-0212     |
| 1. Hood SR 520 S/M                                 | H06-0312     |
| 2. Hood SR 530                                     | H06-0412     |
| 3. Face shield SR 570                              | H06-6512     |
| 4. Full face mask SR 200, PC visor                 | H01-1212     |
| 4. Full face mask SR 200, glass visor              | H01-1312     |
| 5. Full face mask SR 200 Airline, PC visor         | H03-1012     |
| 5. Full face mask SR 200 Airline, glass visor      | H03-1212     |
| 6. PU hose SR 550 for SR 200                       | T01-1216     |
| 6. Rubber hose SR 551 for SR 200                   | T01-1218     |
| 7. SR 900 S  | H01-3012     |
| 7. SR 900 M  | H01-3112     |
| 7. SR 900 L  | H01-3212     |
| 8. Hose SR 951                                     | T01-3003     |
| 9. Twin hose SR 952                                | R01-3009     |
| 10. Hood SR 561                                    | H06-5012     |
| 11. Hood SR 562                                    | H06-5112     |
| 12. Welding shield SR 592                          | H06-4412     |
| 13. Helmet with visor SR 580                       | H06-8012     |
| 14. Welding shield/Helmet with visor SR 584/SR 580 | H06-8310     |
| 15. Hood SR 601                                    | H06-5412     |
| 15. Hood SR 602                                    | H06-5512     |
| 16. Flow meter SR 356                              | R03-0346     |
| 17. Steel net disc SR 336                          | T01-2001     |
| 18. Asbestos Kit SR 509                            | T06-0105     |
| 19. Battery SR 501, 2,25 Ah                        | R06-0108     |
| 19. Battery HD SR 502, 3,5 Ah                      | T06-0101     |
| 20. Battery charger SR 513                         | R06-0103     |
| 21. Charging station without chargers SR 506       | T06-0108     |
| 21. Charging station, complete SR 516              | T06-0111     |
| 22. Belt SR 508                                    | R06-0101     |
| 22. Rubber belt SR 504                             | T06-0104     |
| 22. PVC belt                                       | T06-0124     |
| 22. Leather belt SR 503                            | T06-0103     |
| 23. Leather belt SR 503, large                     | T06-0107     |
| 24. HD belt SR 553, standard                       | T06-0119     |
| 24. HD belt SR 553, large                          | T06-0120     |
| 25. Harness SR 552                                 | T06-0116     |
| 26. Fan SR 500, bare                               | R06-0110     |
| 27. Splash cover SR 514                            | T06-0114     |
| 28. Storage bag SR 505 w two compartments          | T06-0102     |
| 29. Pre-filter holder SR 512                       | R06-0106     |
| 30. Pre-filter SR 221                              | H02-0312     |
| 31. Particle filter P3 R, SR 510                   | H02-1312     |
| 32. Filter adapter SR 511                          | R06-0105     |
| 33. Pre-filter holder for SR 710                   | R01-0605     |
| 34. Particle filter P3 R, SR 710                   | H02-1512     |
| 35. Gas filter A2, SR 518                          | H02-7012     |
| 36. Gas filter ABE1, SR 515                        | H02-7112     |
| 37. Gas filter A1BE2K1, SR 597                     | H02-7212     |
| 38. Combined filter A1BE2K1-Hg-P3 R, SR 599        | H02-7312     |
| 39. Gasket for fan                                 | R06-0107     |
| 40. Plug kit                                       | R06-0703     |

